



SikaRoof® ANCHOR SYSTEM

THE MULTIPURPOSE INTEGRATED FIXING POINT FOR ROOF ACCESSORY MOUNTING

SikaRoof® ANCHOR SYSTEM

GENERAL PRODUCT INFORMATION

The SikaRoof Anchor is a universal integrated fixing point that securely attaches a wide variety of roof mounted equipment directly to the structural roof deck whilst maintaining the integrity of the Sikaplan® PVC or Sarnafil® FPO waterproofing membranes.

Engineered for new construction and retrofit applications on existing Sika roofs, the SikaRoof® Anchor is suitable for attaching the Sika® SolarRoof PV Framing System as either an attached, secured or ballasted system, roof plant support frames, service supports, walkways and many other applications.

SikaRoof® Anchor 250 mm CR



DESCRIPTION

The SikaRoof® Anchor consists of the 2 components:

1. SikaRoof Anchor 250 mm CR PVC or FPO preformed connection point with M12 connector.
2. SikaRoof Anchor Washer 140mm stainless steel mounting with integrated M12 bolt.

APPEARANCE / COLOUR

Membrane:

- Beige
- Window grey (~RAL 7040)
- Lead/Basalt Grey (RAL 7012)
- Light grey (~RAL 7047)

Washer:

- Stainless steel

APPLICATION

SikaRoof® Anchor can only be installed by Sika® trained installers. Universal connection point for fixing roof mounted products to exposed Sarnafil® / Sikaplan® FPO or PVC roof waterproofing membranes.

Where 2 fasteners are used to secure the SikaRoof Anchor to a profiled steel deck the fasteners must be installed in the direction of the deck.

SikaRoof® Anchor Washer 140 mm



SikaRoof® Anchor 250 mm CR	Lead/ Basalt Grey	Window grey	Light grey
FPO	●	●	
PVC	●		●

Features	Advantages	Benefits
Anchor welding flange Ø 250 mm	Easy to hot air weld	Secure watertight connection to the roofing membrane
Anchor welding flange made of Sika compound	Compatible with Sika® single-ply membranes	Resistant to weathering and UV exposure
Various colors of anchor welding flange available	Fits with the color of the roofing membrane	No visible color deviation on the roof surface
Anchor has M12 internal thread for easy transition	Ease of application of further build-up	A broad range of further build-up systems possible
All metal parts are made of stainless steel	No corrosion expected	Long lifespan
Octagon washer with Ø 140 mm	Sufficient load distribution	Removes the windload off the membrane onto the structural deck
Washer with fastener holes 7.20 and 15.35 mm	Also suitable for Sarnabar® Tube fastening system	Wider range of thermal insulation can be used
Anchors arranged as point fastening	Free waterflow to the rainwater outlets is ensured	No additional weight on the roof due to ponding water

SikaRoof® ANCHOR SYSTEM

GENERAL PRODUCT INFORMATION

TECHNICAL INFORMATION

SikaRoof® Anchor 250 mm CR

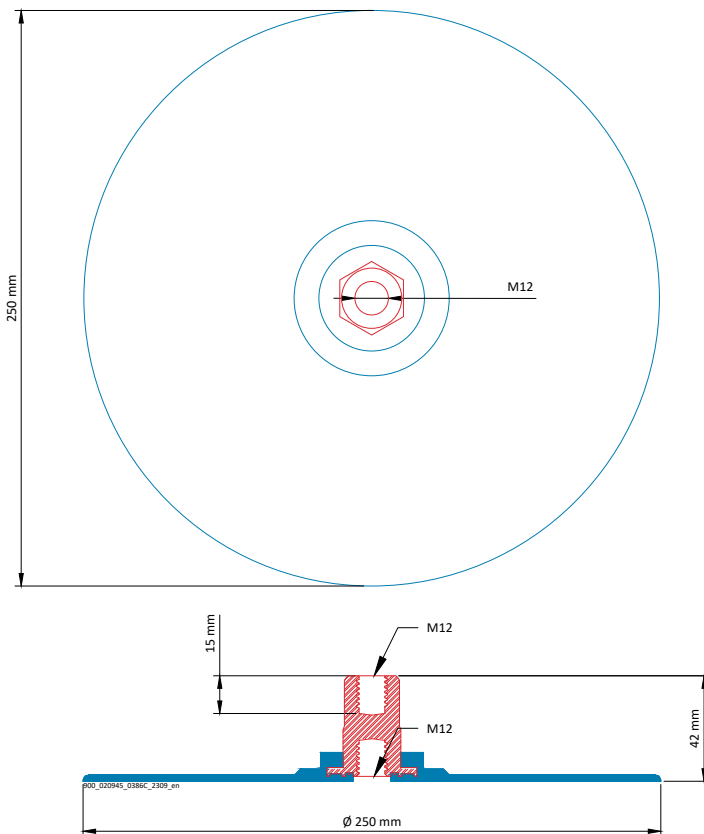

SikaRoof® Anchor Washer 140 mm

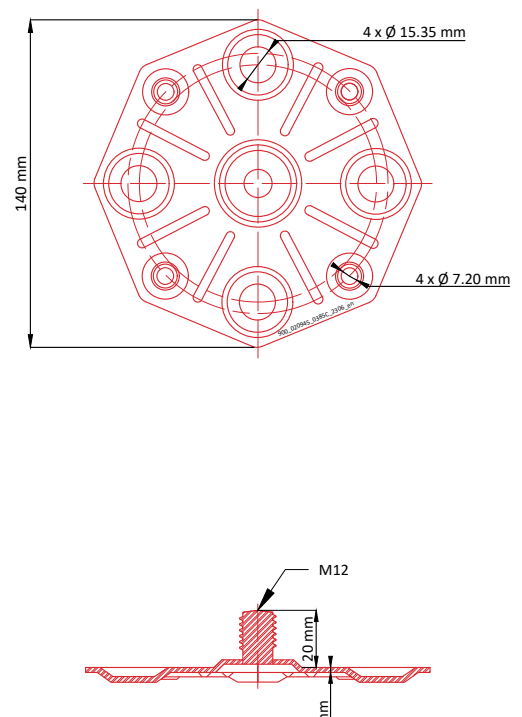

TYPICAL APPLICATION

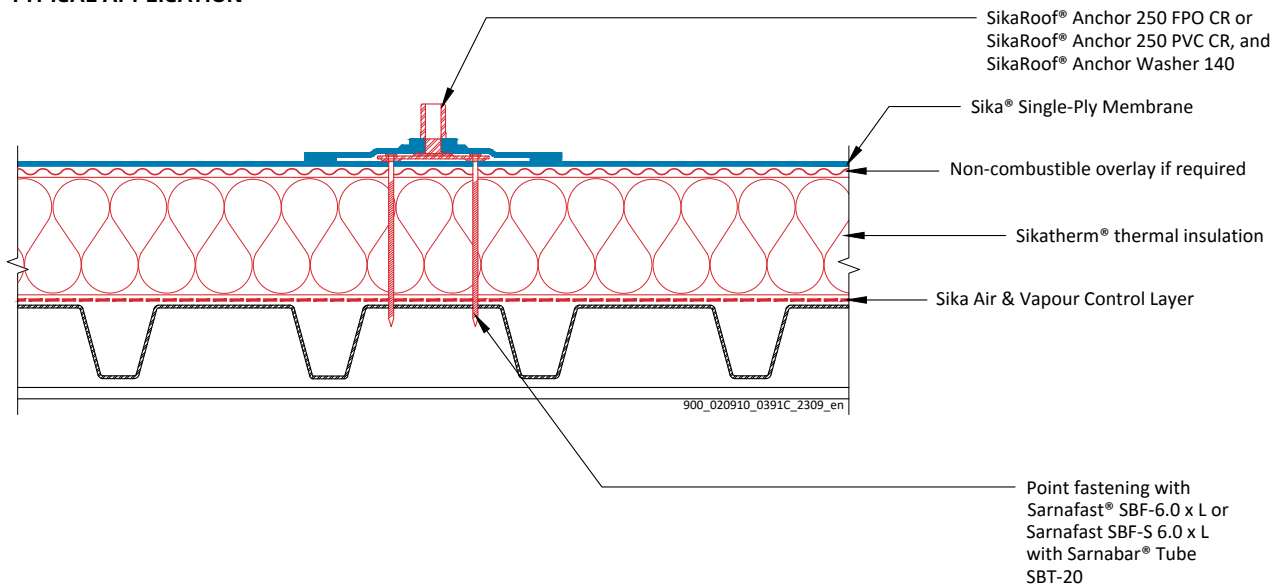

SikaRoof® ANCHOR SYSTEM

INSTALLATION AND FASTENING SELECTION

Easy, safe and reliable installation, all done by the trained Roofing contractor.



Sarnafast® Fastener SBF-6.0 or alternatively Sarnafast® Fastener SBF-S 6.0 with Sarnabar® Tube SBT-20. Stainless steel fasteners may be required subject to guarantee.

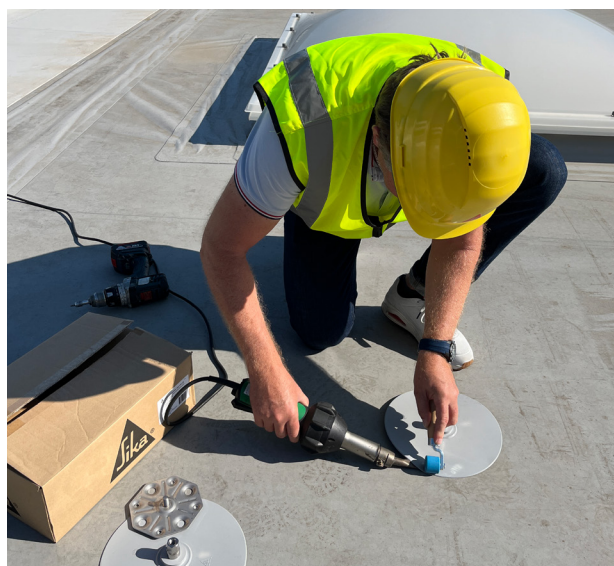

SikaRoof® Anchor 250 mm CR screwed onto the SikaRoof® Anchor Washer 140 mm and tightened to a torque setting of 25/Nm and hot air welded to the roof waterproofing membrane.

Sarnafast® Fastener SBF-6.0/SBF-S 6.0



DESCRIPTION

Hardened carbon steel fastener.

USES

Fastener in combination with SikaRoof® Anchor Washer 140 mm and Sarnabar® Tube SBT-20 into corrugated steel, concrete and plywood / OSB decks.

CHARACTERISTICS / ADVANTAGES

- Resistance against common environmental influences
- Easy application in use with recommended setting tools

- Self drilling fastener, no pre-drilling for steel and plywood / OSB applications
- Recyclable

TECHNICAL INFORMATION

Diameter: 6.00 mm
Head diameter: 9.80 mm
Available lengths: 35 – 300 mm
Torx T25
Corrosion resistance:
15 cycles according to Kesternich

Sarnabar® Tube SBT-20



DESCRIPTION

Polyamide tube (PA 6) for the perimeter fastening and induction welding.

USES

Tube in combination with Sarnafast® Fastener SBF-6.0 on all decks.

CHARACTERISTICS / ADVANTAGES

- High resistance against mechanical inputs
- Lightweight
- Resistance against common environmental influences

- Easy application in use with recommended setting tools
- Recyclable

TECHNICAL INFORMATION

Diameter: 20 mm (at collar)
Hole diameter: 12.40 mm
Available lengths: 40 – 400 mm
30 h conditioned in conditioning cell

SikaRoof® ANCHOR SYSTEM

SikaRoof® ANCHOR WASHER 140 MM - FASTENER SYSTEM SELECTION



SikaRoof® Anchor Washer 140 mm fixed with Sarnafast® Fastener SBF-6.0.

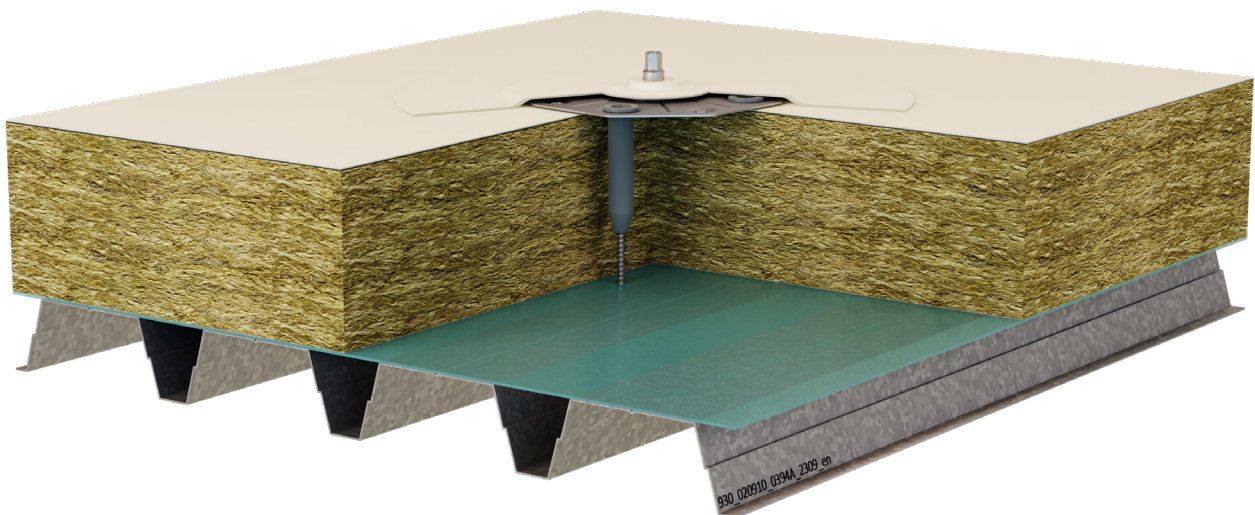

SikaRoof® Anchor Washer 140 mm fixed with Sarnafast® Fastener SBF-6.0 together with Sarnabar® Tube SBT-20.

SikaRoof® ANCHOR SYSTEM

POSSIBLE INSTALLATION OF SOLAR PANELS AND OTHER APPLIANCES



Integrated M12 thread facilitates simple assembly onto the roof. Example shows application of the Sika® SolarRoof PV mounting system



Versatile installation of various appliances / equipment onto the SikaRoof® Anchor System.

SIKA FULL RANGE SOLUTIONS:



LIQUID APPLIED
ROOFING



SINGLE PLY ROOFING



BITUMINOUS ROOFING



CONCRETE



CONCRETE REPAIR



STRUCTURAL
STRENGTHENING



BUILDING FINISHING



WATERPROOFING



JOINT SEALING



FAÇADES



FLOORING



INDUSTRY



DISTRIBUTION



MODULAR/OFFSITE

WHO WE ARE

Sika Limited and Sika Ireland Limited are part of the global Sika Group, specialising in the manufacture and supply of chemical based products. Sika has a global leading position in the development and production of systems and products for bonding, sealing, damping, reinforcing, and protection in the building sector and motor vehicle industry. Sika has subsidiaries in 102 countries around the world and, in over 400 factories, produces innovative technologies for customers worldwide. In doing so, it plays a crucial role in enabling the transformation of the construction and vehicle industries toward greater environmental compatibility. With more than 34,000 employees, the company generated sales of CHF 11.76 billion (£10.35 bn) in 2024.

In the UK and Ireland, we provide market-leading solutions for building finishing, concrete, waterproofing, roofing, flooring, refurbishment, sealing & bonding, and industry, and have manufacturing sites in Welwyn Garden City, Preston, Leeds, Wishaw, Redditch, and Dublin with more than 1000 employees and a turnover of more than £390 million.

The information, and, in particular, the recommendations relating to the application and end use of Sika® products, are given in good faith based on Sika's current knowledge and experience of the products when properly stored, handled and applied under normal conditions. In practice, the differences in materials, substrates and actual site conditions are such that no warranty in respect of merchantability or of fitness for a particular purpose, nor any liability arising out of any legal relationship whatsoever, can be inferred either from this information, or from any written recommendations, or from any other advice offered. The proprietary rights of third parties must be observed. Please refer to our homepage www.sika.co.uk for our current standard terms & conditions applicable to all orders. Users should always refer to the most recent issue of the Product Data Sheet for the product concerned, copies of which will be supplied on request.



SIKA LIMITED

Head Office
Watchmead
Welwyn Garden City
Hertfordshire, AL7 1BQ
United Kingdom

Contactt

Phone +44 1 707 394444
Fax +44 1 707 329129
E-Mail enquiries@uk.sika.com
www.sika.co.uk
X @SikaLimited
in @Sika

SIKA IRELAND LIMITED

Sika House
Ballymun Industrial Estate
Dublin 11
D11 DA2V
Ireland

Contact

Phone +353 1 862 0709
Fax +353 1 862 0707
E-Mail info@ie.sika.com
www.sika.ie
X @SikaIreland

BUILDING TRUST

