



SOLUTIONS FOR ROOFS

Sikalastic® RoofPro
Polyurethane Membranes



LIQUID WATERPROOFING SYSTEMS FOR FLAT ROOFS



Sika has been manufacturing high performance protection and waterproofing systems for over 50 years. The Sikalastic® RoofPro polyurethane coating is a single component, cold applied, moisture-triggered, liquid waterproofing membrane, that cures to form a seamless, durable and weather resistant waterproofing solution for exposed roof areas. The range has all the inherent advantages of using liquid membranes, as well as offering the benefit of being a cost effective alternative to other options available in the market.

Sikalastic® RoofPro incorporates technology that allows the material to use atmospheric moisture to trigger the curing process. This means that the waterproofing membrane is capable of curing in a wide range of conditions, making it ideal for use in the unpredictable UK climate. Unlike traditional polyurethane systems, it does not release CO₂, which can cause gassing, and application is not delayed by adverse weather, which means roofing works are not slowed down.

SYSTEM FEATURES:

- **Cold Applied** – cold applied application
- **Seamless** – eliminating the possibility of joint failure through poor workmanship
- **Quick and Easy Application** – using glass fibre matting to allow simple application in detail areas
- **Cost Effective** – especially on complex roofs
- **High Elasticity** – allowing for greater thermal movement
- **Guarantees** – BBA in excess of 25 years and guaranteed upto 20 years
- **UK Technical Assessments (UKTA)** issued by British Board of Agreement (BBA) Sikalastic® D-10 RoofPro Advanced (UKTA-0836-23/6853) Sikalastic® D-105 RoofPro (UKTA-0836-23/6852)



Sikalastic® D-10 RoofPro and Sikalastic® D-15 Advanced RoofPro



EASY APPLICATION USING 225G GLASS FIRBE MATTING

The membrane is applied in two coats: an embedment coat, which is reinforced with 225g Glass Firbe Matting (chopped strand 225G glass fibre mat), and once this is cured, a top coat is added to complete the system.

The small amounts of solvent present within the polyurethane product 'breaks down' the emulsion binder in the matting, enabling it to become easily moulded around detail areas, allowing quick application, particularly on complex roofs.

The glass fibre mat provides the membrane with exceptional tensile strength, to withstand thermal movement in the substrate.

Sikalastic® RoofPro WATERPROOF COATING

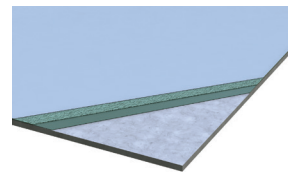

Cures to form a seamless, durable and weather-resistant waterproofing solution for exposed roof areas.

System build-up:

- Sikalastic® RoofPro/Advanced Top Coat
- Sika® Reemat Premium Embedded
- Sikalastic® RoofPro/Advanced Embedment Coat
- Substrate*
- *prime as required

Sikalastic® RoofPro WATERPROOF COATING FOR WARM ROOFS

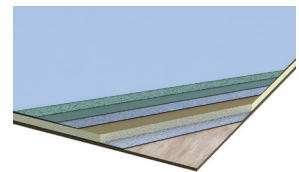

Cures to form a seamless, durable and weather-resistant waterproofing solution for warm roof areas.

System build-up:

- Sikalastic® RoofPro/Advanced Top Coat
- Sika® Reemat Premium Embedded
- Sikalastic® RoofPro/Advanced Embedment Coat
- S-Vap 5000 E SA
- Primer-600
- Insulation adhesive
- S-Vap 5000 E SA
- Substrate*
- * Primer-600
- * Substrate - OSB3 18mm or Plywood 18mm
- *For other substrates, prime as required.

THE RIGHT ROOFING SOLUTION, FOR EVERY PROJECT

REFURBISHMENT



Sikalastic® D-10 RoofPro

Single Component, Liquid Applied Polyurethane Waterproofing Membrane

Sikalastic® D-10 RoofPro is a moisture-triggered polyurethane membrane that cures to form a seamless, durable, weather-resistant, and waterproofing solution, for both refurbishment and new build work.

Used for: roof waterproofing solutions in both refurbishment and new build work, for roofs displaying complex detail areas, even when accessibility is limited. In addition, it can be used for the cost-efficient life cycle extension of failing roofs.

- Single component - no mixing, easy, and ready to use
- Cold-applied with a quick and easy application, by spray, brush, or roller
- Seamless membrane, based on moisture-triggered chemistry
- Waterproof and vapour permeable
- Elastic - retains flexibility at low temperatures, and is tolerant of thermal movement
- Fast curing - free from rain damage almost immediately on application
- 10 Year Guarantee - when installed by an Approved Roof Assured by Sika Installer



Sikalastic® D-15 RoofPro Advanced

Single Component, High Performance Liquid Applied Polyurethane Waterproofing Membrane

Sikalastic® D-15 RoofPro Advanced is a moisture-triggered polyurethane membrane that cures to form a seamless, durable, weather-resistant, and waterproofing solution, for both new build and refurbishment projects.

Used for: waterproofing of flat and pitched roof structures, communal walkways, podium decks, and terraced roofs. It is applicable to existing concrete, roofing felt, brickwork, and asbestos cement decks (subject to condition and priming requirements).

- Single component - no mixing, easy, and ready to use
- Cold-applied with a quick and easy application, by spray, brush, or roller
- Seamless membrane, based on moisture-triggered chemistry
- Waterproof and vapour permeable
- Elastic - retains flexibility at low temperatures, and is tolerant of thermal movement
- Can be applied all year round, above +2°C
- 15/20 Year Guarantee - when installed by an Approved Roof Assured by Sika Installer
- BBA Certified

SIKA FULL RANGE SOLUTIONS FOR CONSTRUCTION:



LIQUID APPLIED ROOFING



SINGLE PLY ROOFING

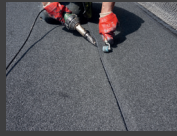

BITUMINOUS ROOFING



CONCRETE



CONCRETE REPAIR



STRUCTURAL STRENGTHENING



BUILDING FINISHING



WATERPROOFING



JOINT SEALING



FAÇADES



FLOORING



INDUSTRY



DISTRIBUTION



BUILDING TRUST

FOR MORE INFORMATION:

WHO WE ARE

Sika Limited and Sika Ireland Limited are part of the global Sika Group, specialising in the manufacture and supply of chemical based products. Sika has a global leading position in the development and production of systems and products for bonding, sealing, damping, reinforcing, and protecting in the building sector and motor vehicle industry. Sika has subsidiaries in 103 countries, manufactures in over 400 factories, and develops innovative technologies for customers around the world that facilitate the sustainable transformation of the construction and transportation industries. With more than 33,000 employees, the company generated annual sales of CHF 10.5 billion (£9.4 bn) in 2022.

In the UK and Ireland, we provide market-leading solutions for building finishing, concrete, waterproofing, roofing, flooring, refurbishment, sealing & bonding, and industry, and have manufacturing sites in Welwyn Garden City, Preston, Leeds, Wishaw, Redditch, and Dublin with more than 900 employees and a turnover of more than £420 million.

The information, and, in particular, the recommendations relating to the application and end use of Sika® products, are given in good faith based on Sika's current knowledge and experience of the products when properly stored, handled and applied under normal conditions. In practice, the differences in materials, substrates and actual site conditions are such that no warranty in respect of merchantability or of fitness for a particular purpose, nor any liability arising out of any legal relationship whatsoever, can be inferred either from this information, or from any written recommendations, or from any other advice offered. The proprietary rights of third parties must be observed. Please refer to our homepage www.sika.co.uk for our current standard terms & conditions applicable to all orders. Users should always refer to the most recent issue of the Product Data Sheet for the product concerned, copies of which will be supplied on request.



SIKA LIMITED

Head Office
Watchmead
Welwyn Garden City
Hertfordshire, AL7 1BQ
United Kingdom

Contact

Phone +44 1 707 394444
Fax +44 1 707 329129
E-Mail enquiries@uk.sika.com
www.sika.co.uk
X @SikaLimited

