

**Key**

- ① — Sikafloor®-415 as per Sika Limited Project Specification
- ② — Sikafloor®-405 with embedded Reemat Premium GFM
- ③ Existing Substrate prepared and primed in strict accordance with Sika Limited Project Specification
- ④ Fully Reinforced Sikafloor® Balcony Waterproofing System dressed as far into existing outlets as practicable

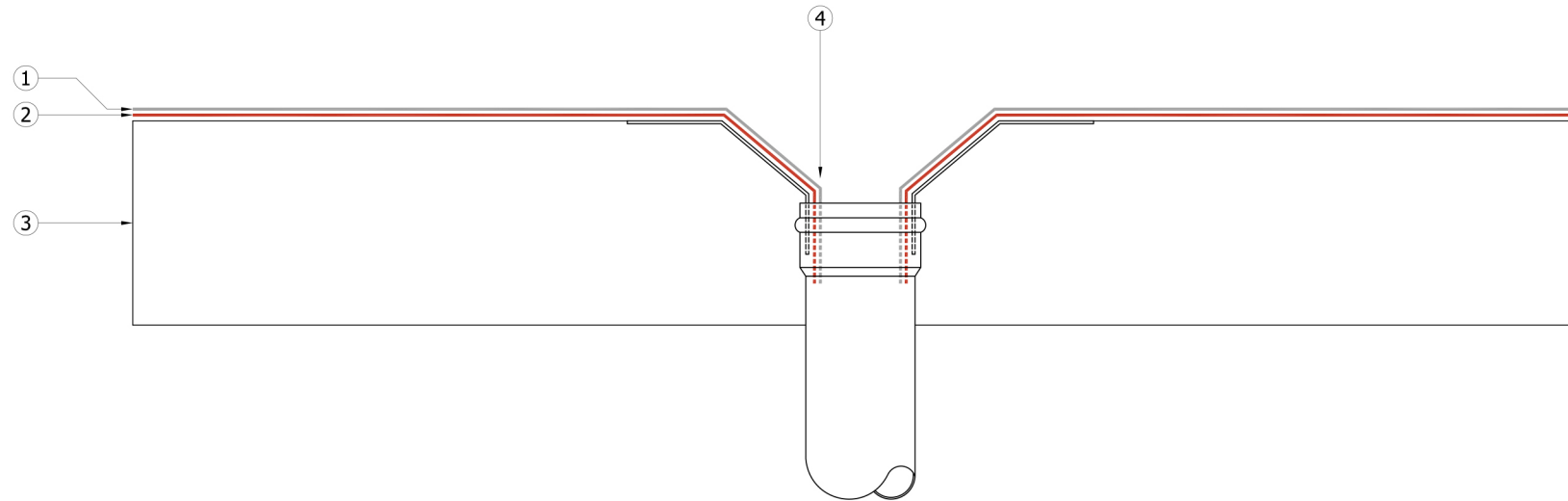

**BUILDING TRUST**

Sika Limited  
Watchmead  
Welwyn Garden City  
Hertfordshire  
AL7 1BQ  
Telephone: 01707 394444  
Email: refurbishmentenquiries@uk.sika.com  
Web: www.sika.co.uk

This drawing is solely intended to illustrate the correct application of Sika Limited products and systems, it must be read in conjunction with the appropriate specification and current issue of relevant Technical Data Sheets. All elements bearing reference to structural and/or thermal design are shown indicatively and should not be used in whole or in part for any aspect of

Project No:

DWG No: Revision

Project:

Drawing Title:  
Waterproofing Termination Detail  
to an existing internal outlet

Scale: NTS @ A3 Drawn:

Date: