

Key

- ① Compatible substrates or decks prepared and primed in strict accordance with Sika Liquid Plastics Project Specification
- ② **SikaFloor®-425 Embedment Coat** fully reinforced with **Sika Reemat Premium** glass fibre matting in strict accordance with Sika Liquid Plastics Project Specification
- ③ **SikaFloor®-425 Top Coat** applied in strict accordance with Sika Liquid Plastics Project Specification
- ④ **SikaFloor®-420 Wearing Coat** applied @ 0.3l/m², broadcast with **Sika Quartz Sand** @ 2.5 - 3.0kg/m². Remove excess grit once cured. Apply a sealing coat of **SikaFloor®-420** @ 0.4l/m². All in strict accordance with Sika Liquid Plastics Project Specification
- ⑤ Fully reinforced Sika Liquid Applied Membrane dressed to the external face of the existing parapet encapsulating **all** capping retention bracket fixings

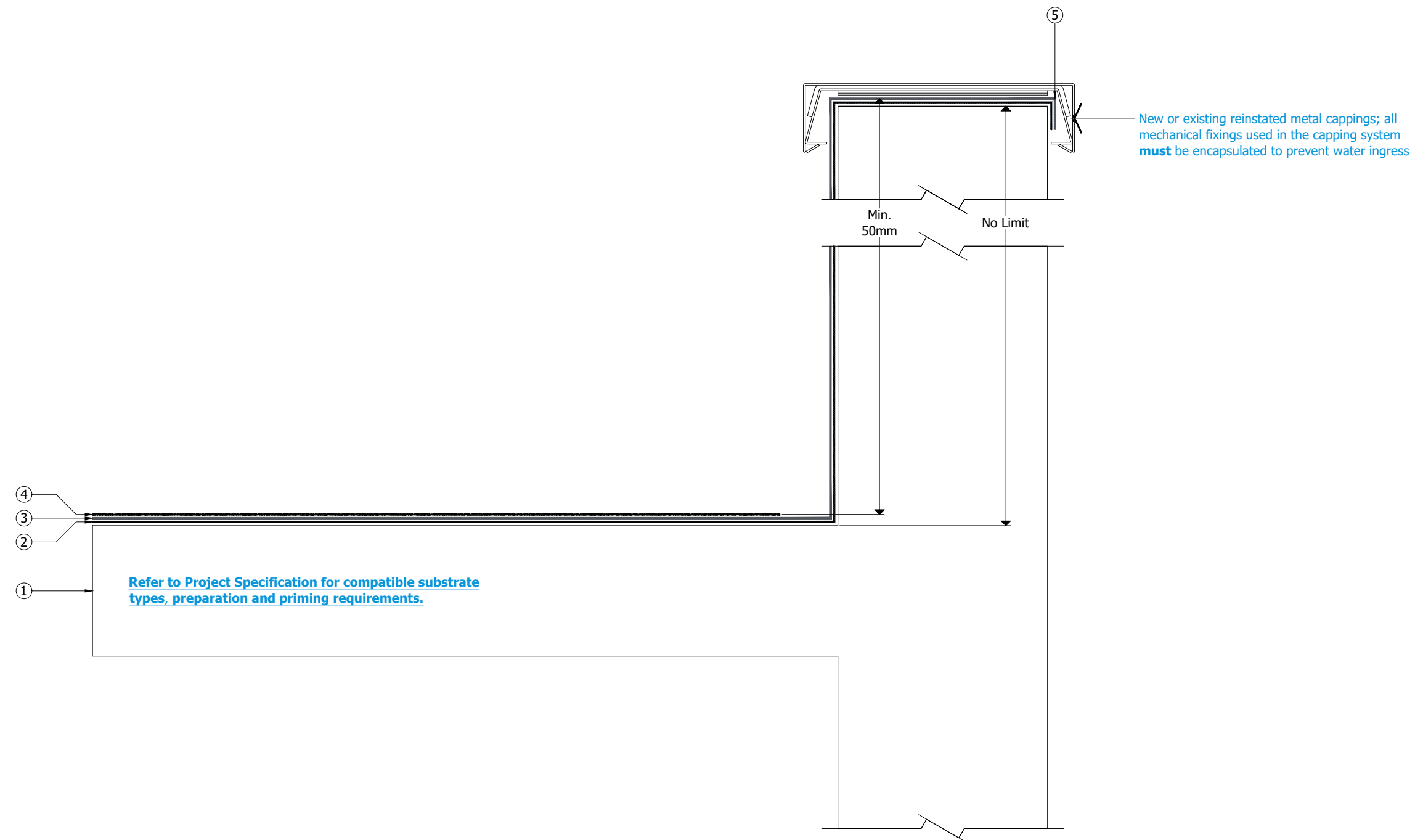
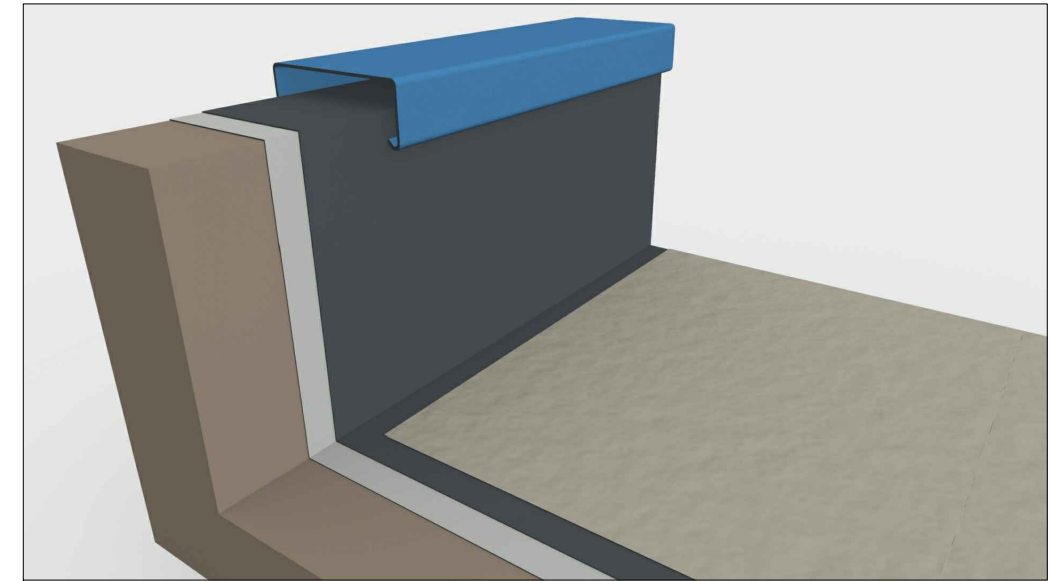

Drawing Status: CONSTRUCTION	
Project N ^o	
DWG N ^o	Revision
Project:	
Drawing Title: SikaFloor® MonoFlex MB-54 LO Balcony/Terrace Waterproofing Encapsulated Parapet with Capping	
Scale: NTS @ A3	Drawn: GRW
Date: September 2021	
<small>This drawing is the confidential property of Sika Limited and must not be reproduced in whole or in part. All rights in respect of patents, design and copyrights are reserved. Moreover it is solely intended to illustrate the correct application of Sika Liquid Plastics products and systems, and must be read in conjunction with the appropriate specification and current issue of relevant Product Data Sheets. Elements bearing reference to structural and/or thermal design are shown indicatively and should not be used for any aspect of project design without consulting the relevant authorities.</small>	
