



LIQUID APPLIED SOLUTIONS FOR ROOFS, WALKWAYS, AND BALCONIES

SIKALASTIC® 625N, DECOTHANE® ULTRA,
SIKA® PRO-TECTA, AND SIKALASTIC® RAPID

BUILDING TRUST



CONTENTS

An Introduction to Liquid Applied Roofing Systems	3
Traditional Flat Roofing	6-7
Sikalastic® 625N	
Decothane Ultra	8
Metal Roofs	
Waterproofing for Metal Roofs and Gutters	12
Sika® Pro-Tecta WP Waterproofing Solutions	13
Walkways and Balconies	
Rapid Trafficable Systems for Walkways, Balconies and Terraces	16
Sikalastic Rapid	17
Sikalastic® Rapid Waterproofing for Flat Roofs and Gutters	18
Sika Service and Support	19

AN INTRODUCTION TO LIQUID APPLIED ROOFING SYSTEMS



“A COLD APPLIED LIQUID SOLUTION FOR EVERY JOB,
NO MATTER THE BUDGET OR COMPLEXITY”

Quality and innovation are just two of the characteristics replicated throughout Sika – visible in our products, manufacturing processes, and research & development.

Since 1963 we have produced an extensive range of high performance, technologically advanced coatings and membranes for the protection and waterproofing of roofs and balconies.

Also available is a complete range of cold applied built-up roofing systems, including warm roofs supporting various finishes.

As a member of the Sika worldwide group, the demand for our products stretches across the globe, and many successful projects have been completed in the Middle East, USA, and Europe.

WE ARE SIKA

BUILDING TRUST



TRADITIONAL ROOFS

SIKALASTIC® 625N

DECOTHANE® ULTRA



POLYURETHANE WATERPROOFING SYSTEMS FOR FLAT ROOFS

SIKALASTIC® 625N



Sikalastic® 625N



Sika has been manufacturing high performance protection and waterproofing systems for over 50 years. The Sika range of flat roof coatings are single component, cold applied and moisture-triggered, that cure to form a seamless, durable and weather resistant waterproofing solution for exposed roof areas. The range has all the inherent advantages of using liquid membranes, as well as offering the benefit of being a cost effective alternative to other options available in the market.

Sikalastic®-625N SOLUTIONS

Sikalastic®-625N incorporates technology that allows the material to use atmospheric moisture to trigger the curing process. This means that the waterproofing membrane is capable of curing in a wide range of conditions, making it ideal for use in the unpredictable UK climate. Unlike traditional polyurethane systems, it does not release CO₂, which can cause gassing, and application is not delayed by adverse weather, which means roofing works are not slowed down.

SYSTEM FEATURES:

- **Cold Applied** - Easily and safely applied in a range of weather conditions
- **Seamless**
- **Quick and Easy Application** - using glass fibre matting to reinforce field areas and complex details
- **High Elasticity** - allowing for thermal movement
- **Guarantees** - 10, 15 and 20 year guarantees available
- **BBA Accreditation** - Validated by the British Board of Agrément, confirming its quality and reliability to rigorous standards
- **i-cure patented technology exclusive to Sika** - Improved cure performance at high temperature and high humidity conditions
- **Full Service Package** - this includes a consultation and roof survey, design and specification, all with guarantee options and site support with every application



APPLICATION OF SIKALASTIC 625N

The membrane is applied in two coats: an embedment coat, which is reinforced with Sika Reemat Premium (chopped strand glass fibre mat), and once this is cured, a top coat is added to complete the system.

The small amounts of solvent present within the polyurethane product 'breaks down' the emulsion binder in the matting, enabling it to become easily moulded around detail areas, allowing quick application, particularly on complex roofs.

The glass fibre mat provides the membrane with exceptional tensile strength to withstand thermal movement in the substrate.

Sikalastic®-625N WATERPROOF COATING

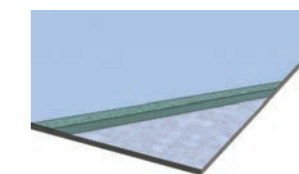

Cures to form a seamless, durable and weather-resistant waterproofing solution for exposed roof areas.

System build up:

- Sikalastic®-625N
 - Sika Reemat Premium Embedded
 - Sikalastic®-625N Embedment Coat
 - Substrate*
- *Prime as required



Sikalastic®- 625N WATERPROOF COATING FOR WARM ROOFS

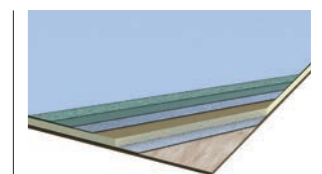

Cures to form a seamless, durable and weather-resistant waterproofing solution for warm roof areas.

System build up:

- Sikalastic®-625N
 - Sika Reemat Premium Embedded
 - Sikalastic®-625N Embedment Coat
 - Carrier Membrane
 - Primer
 - Sikatherm insulation
 - Sika Insulation adhesive
 - Air and Vapour Control Layer
 - Primed substrate
 - Substrate*
- *Prime as required

SIKALASTIC®
PU✓

SIKALASTIC®
PU✓

WITH LOW ODOUR DECOTHANE ULTRA

IT'S BUSINESS AS USUAL...



Through careful engineering and true innovation, Sika has developed Decothane Ultra using patented i-cure low odour technology to enable use on highly sensitive sites, such as hospitals, food manufacturing plants, and schools.

Decothane Ultra establishes a new benchmark amongst single pack polyurethanes, and presents opportunities for architects, specifiers and contractors, to use liquid waterproofing within these niche and specialised markets.

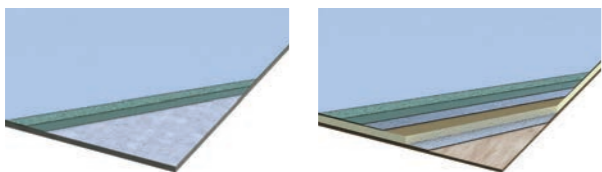

FEATURES AND BENEFITS

- **Low Odour** - Third party verification of low odour performance
- **Cold Applied** - Easily and safely applied in a range of weather conditions
- **Seamless**
- **Rapidly Rain Resistant** - free from rain damage immediately after application.
- **Easy Installation** - Quick and easy application - using glass fibre matting to reinforce field areas and complex details
- **High Elasticity** - allows for greater thermal movement and durability
- **Dedicated Base Coat Solution**
- **Guarantees** - 15, 20 and 25 year systems are available
- **Full Service Package** - this includes a consultation and roof survey, design and specification, all with guarantee options and site support with every application.
- **BBA Accreditation** - Validated by the British Board of Agrément, confirming its quality and reliability to rigorous standards



Olfasense are a team of independent consultants that develops, manages and delivers top level expertise on sensory analysis techniques and their application for product optimisation and material testing. According to test data, Decothane Ultra was scientifically proven to have a much lower odour when benchmarked against other single pack polyurethanes available in the market.



MANUFACTURING SITE, CRAMLINGTON

Decothane Ultra 20 Year System



METAL ROOFS

SIKA® PRO-TECTA



WATERPROOFING FOR METAL ROOFS AND GUTTERS



Metal sheeting has remained popular across many sectors, including industrial, retail, and leisure. The main driving factor is often the ease and speed at which the framework structure of the building can be erected, and the envelope encapsulated.

In the context of metal sheeting, used as a pitched roofing material, large profiled roof sheets are often an attractive proposition, because of a good coverage rate per sheet, and their ability to discharge water effectively over a large area. However, exposure factors, such as geographical location, combined with the type of sheet, and its coating, will greatly influence the lifespan of metal roofs. At some point, most metal roofs will require maintenance and attention, to address possible degradation of the protective coating, and in some cases, corrosion of the metal sheet core, which, if left untreated could undermine the primary waterproofing function.

Sika has a strong and proven background in providing high performance waterproofing coatings for metal roofs, across the country – successfully extending service life, backed by guarantee.

SYSTEM FEATURES:

- **Lightweight Coating** – cost effective alternative to over cladding, minimising disruption to building operations
- **Seamless** – the opportunity for windblown rain to penetrate the seams of the cladding is eliminated and the building is kept watertight
- **High elasticity** -allows for thermal movement
- **Quick and easy application** - using Sika Joint Tape to reinforce end-laps, side-laps and bolt heads
- **Guarantees** - 10 and 15 and 20 year guarantees available
- **BBA Accreditation** (Certificate No: 16/5294)

Sika has a range of metal roof systems, to provide a solution for every project requirement, and every budget, within the Sika® Pro-Tecta range.

GUTTERS

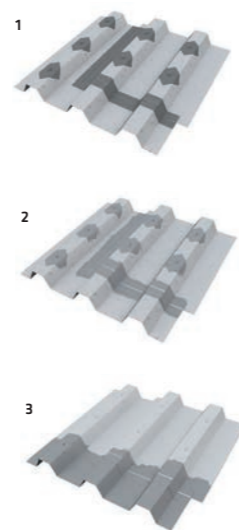

SYSTEM BUILD UP:

- Sikalastic®-625N or Decothane® Ultra (two coats)
- Light application of coating to Sika® Joint Tape SA
- Sika® Joint Tape SA (side laps, end laps and bolt heads)
- Existing substrate*
*Prime as required



SIKALASTIC®
PU✓

SIKA® PRO-TECTA WP WATERPROOFING SOLUTIONS



Sika® Joint Tape SA

It is very often the case that metal roof systems require a more extensive refurbishment solution, particularly where sheets are damaged or leaking.

Sika has extensive experience in the full waterproofing of metal roof systems, using our high performance liquid membranes.

The specification of our liquid systems, as a full waterproofing solution, offers many benefits, including, cost, speed of application, and minimal disruption to building operations – backed by a full waterproofing guarantee.

Sika® Pro-Tecta WP is our waterproofing system, which has been engineered around our two flagship polyurethane membranes: Sikalastic®-625N and Decothane® Ultra as a low odour option.



Sika® Joint Tape SA

Sika Joint Tape SA is used as a single-solution for the reinforcement of side-laps, end-laps, and bolt-heads, prior to the application of our liquid coatings, without the need for additional specialist reinforcement coatings.

Reinforcement of laps and bolt-heads is often one of the most time-consuming elements associated with the installation of liquid waterproofing systems on metal roofs. Sika Joint Tape SA dramatically reduces installation time and greatly simplifies the overall system.

ADDITIONAL SOLUTIONS FOR METAL ROOFS

Safety:

Fall protection systems



Accessories:

Fixings: Fixing specification and replacement service



SIKA® PRO-TECTA
WP



WALKWAYS AND BALCONIES

SIKALASTIC® RAPID



RAPID TRAFFICABLE SYSTEMS FOR WALKWAYS, BALCONIES AND TERRACES

Sikalastic® Rapid Range



The Sikalastic® Rapid range has been developed to be used in situations where the contractor's access to the area may be restricted, and a fast application is desirable. A typical scenario may be a communal walkway or stairwell within a housing block, frequently seen in urban areas, where residents require access to their home within an acceptable time period.

The Sikalastic® Rapid range is based on PMMA (polymethyl methacrylate) technology, which offers the fastest cure of any liquid applied membrane in the market, even in lower temperatures. The product has the ability to cure in 30-40 minutes and can be accelerated if required.

The systems available are compatible with almost all substrates, are exceptionally hard wearing, and are proven to withstand the demands of the walkway, balcony and terrace environment, giving reliable waterproofing and protection, in combination with functional surfacing.

Decorative options are available with the use of Sikalastic® Rapid clear and pigmented sealers in conjunction with quartz sand.

WATERPROOFING OF STAIRS AND STAIRWELLS

Sikalastic® Rapid Structured Coating RA is available for areas requiring a more heavy duty finish, such as stairwells and access ramps. When used with a proprietary edge nosing, it provides a long term protective wearing solution.



SIMPLE WET-ON-WET APPLICATION

This means that the polyester reinforcing fleece is first saturated with Sikalastic® Rapid-721 resin, bonding the membrane to the substrate, with the surface layer then applied onto the bonding coat whilst still wet, so forming a single seamless membrane of uniform thickness. The advantage of PMMA technology is that on balconies and terraces, a one day application may be possible, because there is no need to wait for drying between coats.

The polyester reinforcing fleece provides the membrane with exceptional tensile strength to withstand thermal movement in the substrate.

SYSTEM FEATURES:

- **Rapid Curing** - allowing areas to be treated quickly, minimising time on site
- **Access Restrictions Minimised** - materials achieve full mechanical properties exceptionally quickly, and can be trafficked shortly after installation
- **Can Be Applied At Very Low Temperatures** - with an ability to still achieve a rapid cure
- **Flexible and Crack-Bridging** - even at extreme sub-zero temperatures
- **Heavy-Duty** - wearing layer option for foot traffic
- **Cold Applied** - eliminating the risk of fire on an occupied building during installation
- **Guarantees** - up to 20 year guarantees available

Sikalastic® Rapid TRAFFICABLE (WEARING)

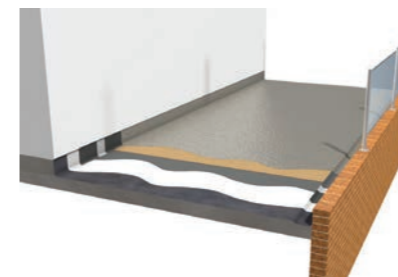

System build up:

- Sikalastic® Rapid Pigmented Sealer
- Sikalastic® Rapid Aggregate
- Sikalastic® Rapid Levelling Mortar
- Sikalastic® Rapid-721 Thixo and Sikalastic® Rapid Fleece 110 (detail areas)
- Substrate*
- *Prime as required

Sikalastic® Rapid TRAFFICABLE (WATERPROOFING & WEARING)

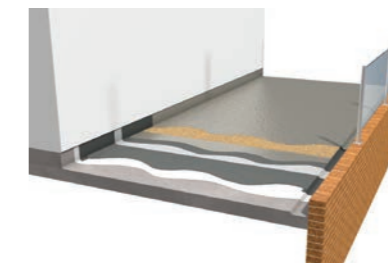

System build up:

- Sikalastic® Rapid Pigmented Sealer
- Sikalastic® Rapid Aggregate
- Sikalastic® Rapid Levelling Mortar
- Sikalastic® Rapid-721 and Sikalastic® Rapid Fleece 110
- Sikalastic® Rapid-721 Thixo and Sikalastic® Rapid Fleece 110 (detail areas)
- Substrate*
- *Prime as required

Sikalastic® Rapid TRAFFICABLE (WATERPROOFING & BURIED)

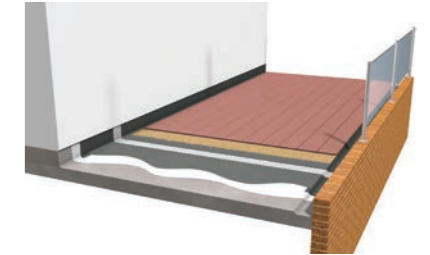

System build up:

- Tiles
- Sikalastic® Rapid Aggregate
- Sikalastic® Rapid-721
- Sikalastic® Rapid-721 and Sikalastic® Rapid Fleece 110
- Sikalastic® Rapid-721 Thixo and Sikalastic® Rapid Fleece 110 (detail areas)
- Substrate*
- *Prime as required



Sikalastic® Rapid WATERPROOFING FOR FLAT ROOFS AND GUTTERS



Sikalastic® Rapid-721 is a polymethyl methacrylate (PMMA), liquid applied roof waterproofing membrane, for use on flat roofs with limited access and gutters, where speed of application is a major advantage. The two component, solvent free, cold applied, liquid resin, cures following an extremely rapid in-situ polymerisation, which is activated by the addition of a peroxide catalyst. This curing proceeds rapidly even at temperatures around 0°C.

The membrane is reinforced with a polyester fleece and is installed wet-on-wet. This means that the polyester reinforcing fleece is first saturated with Sikalastic® Rapid-721 resin, bonding the membrane to the substrate, with the surface layer then applied onto the bonding coat whilst still wet, so forming a single seamless membrane of uniform thickness. The advantage of PMMA technology is that on smaller roofs a one day application may be possible, because there is no need to wait for drying between coats.

SYSTEM FEATURES:

- **Rapid Curing** – allowing areas to be treated quickly, minimising time on site
- **Wet on Wet Application** – membrane and reinforcement applied in one operation, minimising time on site
- **Access Restrictions Minimised** – the materials achieve full mechanical properties exceptionally quickly
- **Cold Applied** – eliminating the risk of fire on an occupied building during installation
- **Seamless** – Provides a continuous membrane that eliminates the risk of joint failure through poor workmanship
- **Can Be Applied At Very Low Temperatures** – with an ability to still achieve a rapid cure
- **Flexible** – even at extreme sub-zero temperatures
- **Guarantees** – 20 year guarantee available

Sikalastic® Rapid ROOF WATERPROOFING SYSTEM

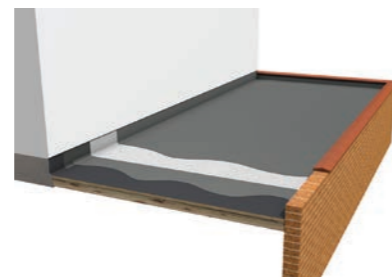

System build up:

- Sikalastic® Rapid-721 and Sikalastic® Rapid Fleece 110
- Sikalastic® Rapid-721 Thixo and Sikalastic® Rapid Fleece 110 (details areas)
- Substrate*
*Prime as required

SIKALASTIC®
RAPID

Sika Service and Support



RANGE OF GUARANTEES

At Sika Roofing, we offer a range of very comprehensive guarantees for projects.

Our Product Guarantee, provides comprehensive cover that the membranes supplied fulfil their waterproofing function, and that all other Sika branded products are compatible with the membranes and fulfil their respective function within the roof build-up.

Our Performance and Performance Plus Guarantees incorporate bespoke design factors such as wind load calculations, U-value calculations and condensation risk analysis and bespoke project details. Design and specifications are backed by our Professional Indemnity (PI) Insurance.

STRAIGHTFORWARD TERMS AND CONDITIONS

Our terms and conditions are laid out in a very easy to understand manner and are included in every guarantee.

TRAINED ROOFING CONTRACTORS

When we offer a guarantee, we specify that the whole system must be installed by a Sika Certified Roofing Contractor or Verified Contractor. This gives our clients the peace of mind that the installing contractor has been trained to use our products correctly and safely. These projects will also be thoroughly inspected by our Sika Technical Site Support Team before guarantees are issued. Our highly experienced Site Support Engineers are entirely dedicated to training our contractors and carrying out comprehensive site inspections. This is a free of charge service and is a requirement of the guarantee.

SIKA ROOFING TECHNICAL SERVICES

The Roofing Technical Services Team provides support by checking and producing SikaShield® Specifications, drainage and insulation cut to falls & U value calculations. In addition they will be able to assist in providing CAD drawings and Health and Safety information. The team are also there to check material orders and to answer any of your technical queries.

Sika Roofing – Training & Site Support

A Range of Roofing Solutions

- 18 Members and 1 Training Apprentice
- 4,564 Site Support Engineer Visits
- 527 Contractors Trained at the Sika Training Academy
- 52 Contractors Attended On-Site Training Support Vehicle Workshops
- 500+ Years of Roofing Knowledge and Experience



SIKA FULL RANGE SOLUTIONS:



LIQUID APPLIED ROOFING



SINGLE PLY ROOFING

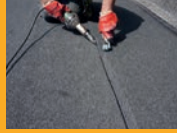

BITUMINOUS ROOFING



CONCRETE



CONCRETE REPAIR



STRUCTURAL STRENGTHENING



BUILDING FINISHING



WATERPROOFING



JOINT SEALING



FAÇADES



FLOORING



INDUSTRY



DISTRIBUTION



MODULAR/OFFSITE

WHO WE ARE

Sika Limited and Sika Ireland Limited are part of the global Sika Group, specialising in the manufacture and supply of chemical based products. Sika has a global leading position in the development and production of systems and products for bonding, sealing, damping, reinforcing, and protecting in the building sector and motor vehicle industry. Sika has subsidiaries in 103 countries, manufactures in over 400 factories, and develops innovative technologies for customers around the world that facilitate the sustainable transformation of the construction and transportation industries. With more than 33,000 employees, the company generated annual sales of CHF 11.2 billion (£9.8 bn) in 2023.

In the UK and Ireland, we provide market-leading solutions for building finishing, concrete, waterproofing, roofing, flooring, refurbishment, sealing & bonding, facades, and industry, and have manufacturing sites in Welwyn Garden City, Preston, Leeds, Wishaw, Redditch, and Dublin with over 1,000 employees and a turnover of more than £380 million.

The information, and, in particular, the recommendations relating to the application and end use of Sika® products, are given in good faith based on Sika's current knowledge and experience of the products when properly stored, handled and applied under normal conditions. In practice, the differences in materials, substrates and actual site conditions are such that no warranty in respect of merchantability or of fitness for a particular purpose, nor any liability arising out of any legal relationship whatsoever, can be inferred either from this information, or from any written recommendations, or from any other advice offered. The proprietary rights of third parties must be observed. Please refer to our homepage www.sika.co.uk for our current standard terms & conditions applicable to all orders. Users should always refer to the most recent issue of the Product Data Sheet for the product concerned, copies of which will be supplied on request.



SIKA LIMITED

Head Office
Watchmead
Welwyn Garden City
Hertfordshire,
AL7 1BQ
United Kingdom

Contact

Phone +44 1 707 394444
Fax +44 1 707 329129
E-Mail enquiries@uk.sika.com
www.sika.co.uk
X @SikaLimited
in @Sika

SIKA IRELAND LIMITED

Sika House
Ballymun Industrial Estate
Dublin 11
D11 DA2V
Ireland

Contact

Phone +353 1 862 0709
Fax +353 1 862 0707
E-Mail info@ie.sika.com
www.sika.ie
X @Sikalreland